

## Setup Office 365 Email Account on MS Outlook (2013/2016)

1. Open “Outlook” on your Computer.

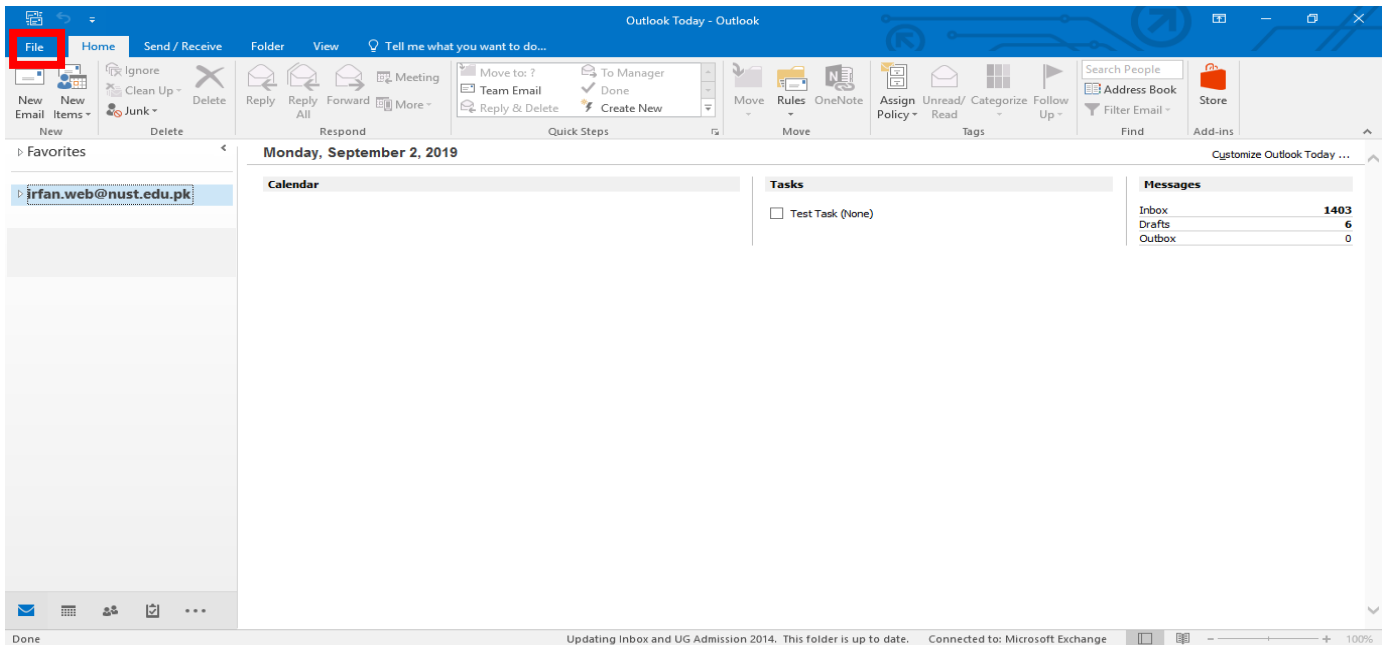

2. Click “File” from top menu and press “Add Account” button.

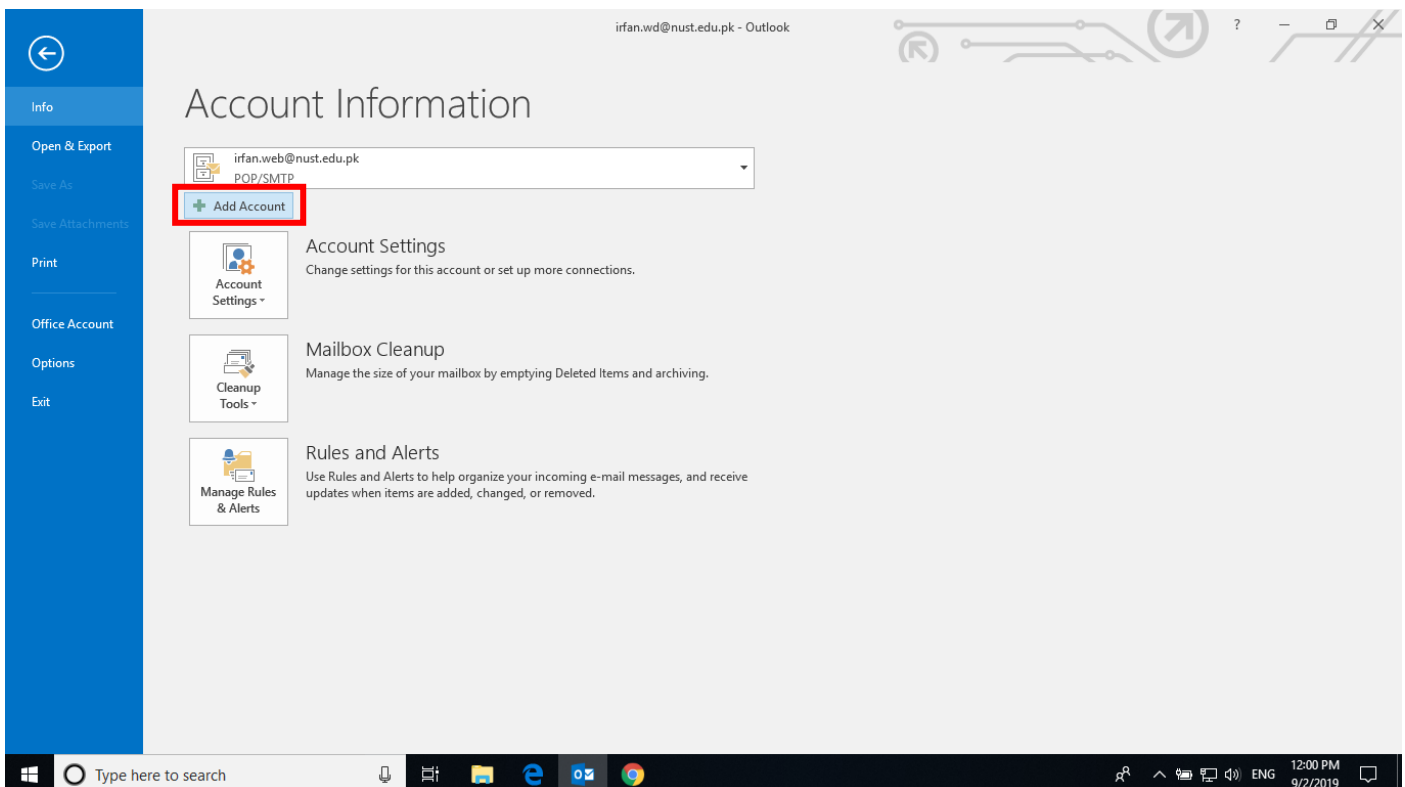

3. Enter your **Email Account** information and press “**Next**” button.

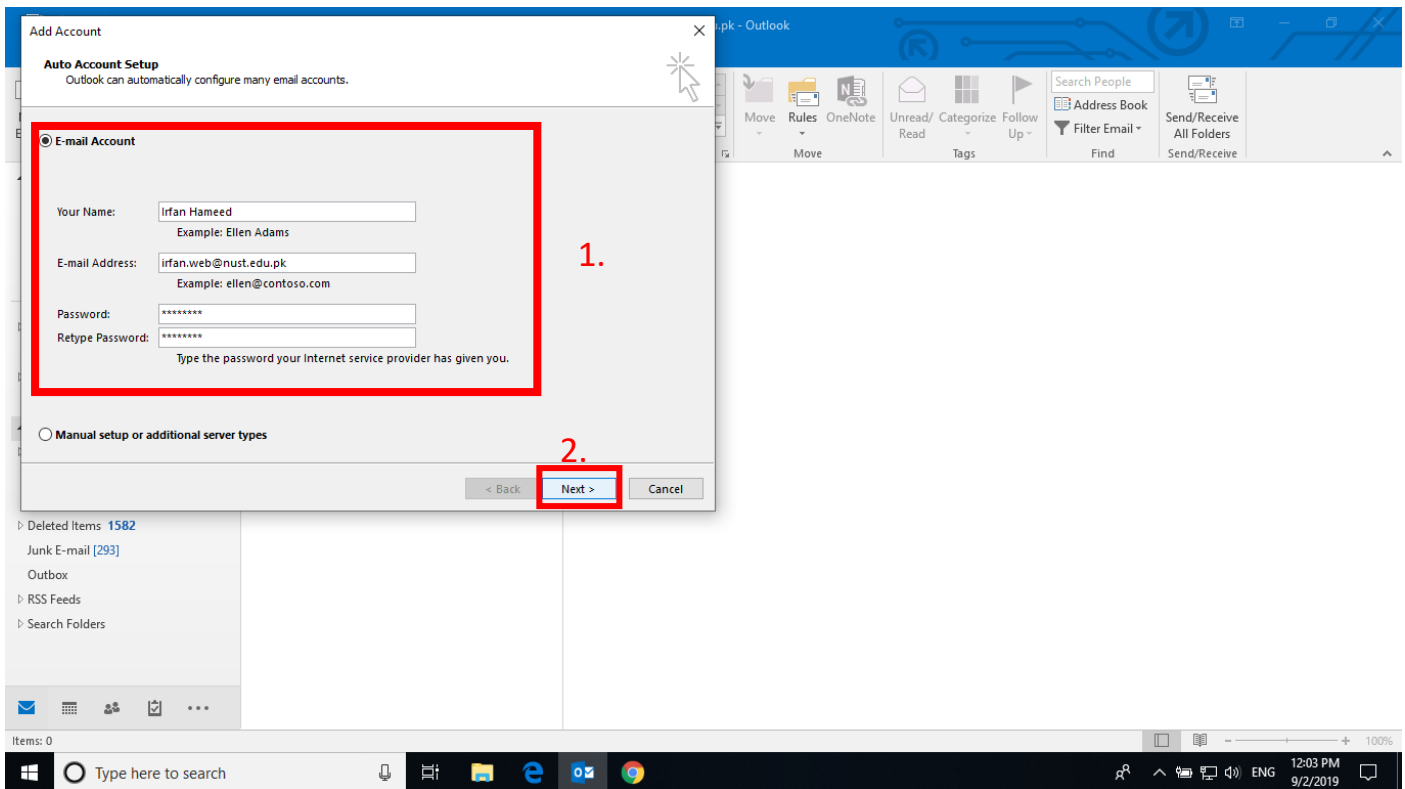

4. System will search settings of Office 365 account. System may prompt for password again.

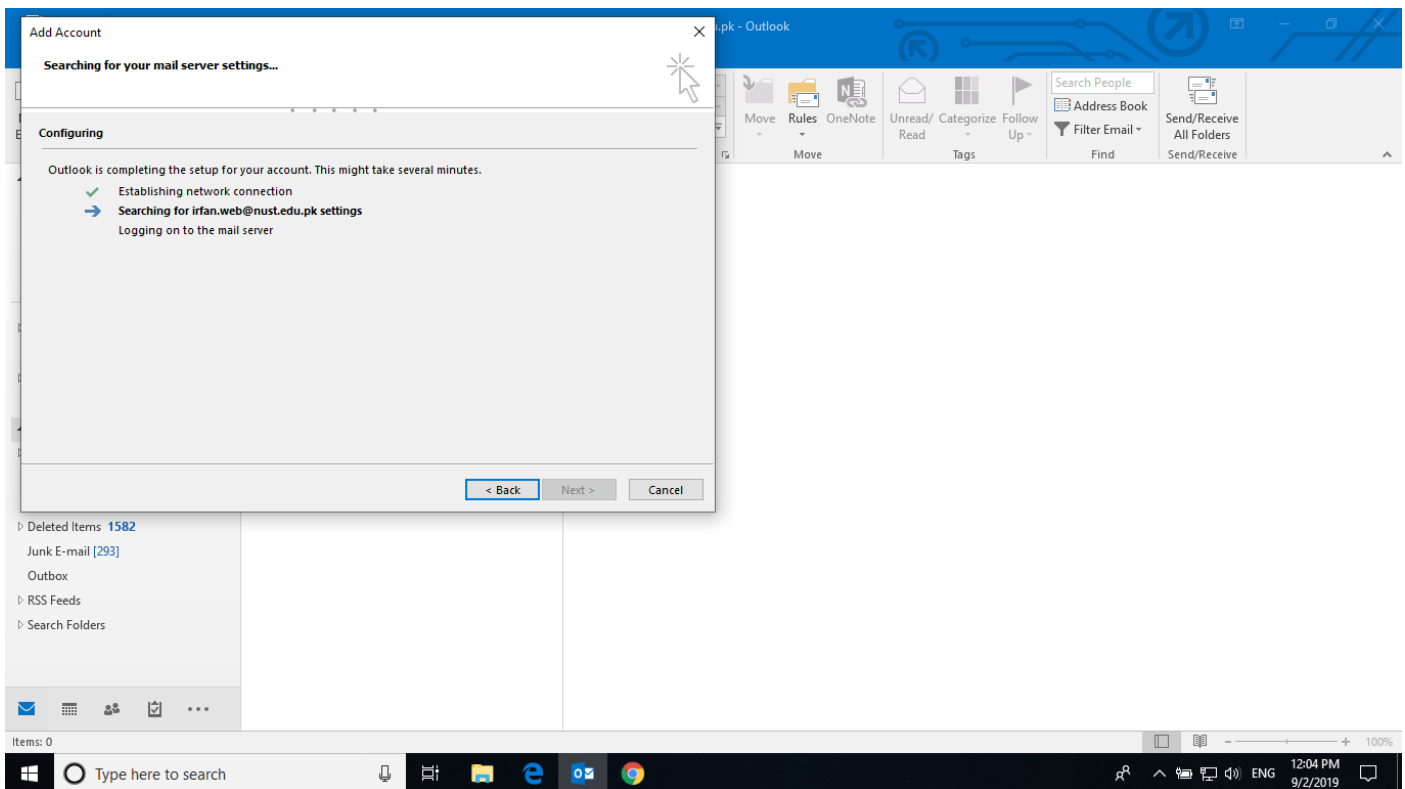

5. Upon successful completion, system will show following screen. Click **“Finish”** to complete the setup.

